

\$249,900 - 11401 Belgrave Road, Rural Grande Prairie No. 1, County of

MLS® #A2202932

\$249,900

0 Bedroom, 0.00 Bathroom,
Land on 0.54 Acres

Carriage Lane Estates, Rural Grande Prairie No. 1, County of, Alberta

PRIME LOCATION, BACKING ONTO POND!
Looking to build your dream home? Look no further than 0.54 acres of land ready to build on backing onto the pond in Carriage Lane Estates. Take advantage of the space and low county taxes today!



Essential Information

MLS® #	A2202932
Price	\$249,900
Bathrooms	0.00
Acres	0.54
Type	Land
Sub-Type	Residential Land
Status	Active

Community Information

Address	11401 Belgrave Road
Subdivision	Carriage Lane Estates
City	Rural Grande Prairie No. 1, C
County	Grande Prairie No. 1, County of
Province	Alberta
Postal Code	T8X0G4

Additional Information

Date Listed	March 17th, 2025
Days on Market	39

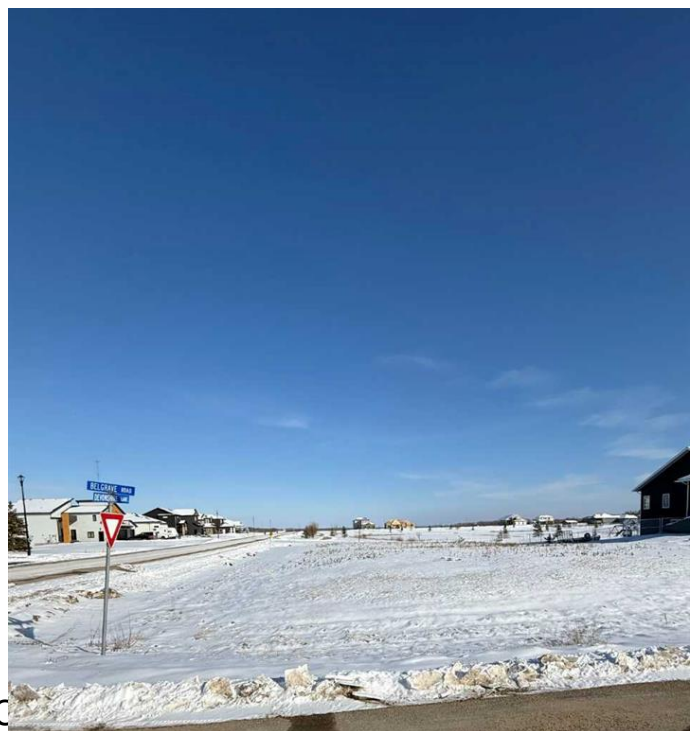

Zoning

RE

Listing Details

Listing Office

Grassroots Realty Group Ltd.

Data is supplied by Pillar 9â„¸ MLSÂ® System. Pillar 9â„¸ is the owner of the copyright in its MLSÂ® System. Data is deemed reliable but is not guaranteed accurate by Pillar 9â„¸. The trademarks MLSÂ®, Multiple Listing ServiceÂ® and the associated logos are owned by The Canadian Real Estate Association (CREA) and identify the quality of services provided by real estate professionals who are members of CREA. Used under license.